

"ALUPLAST" SHELVING ASSEMBLY INSTRUCTIONS

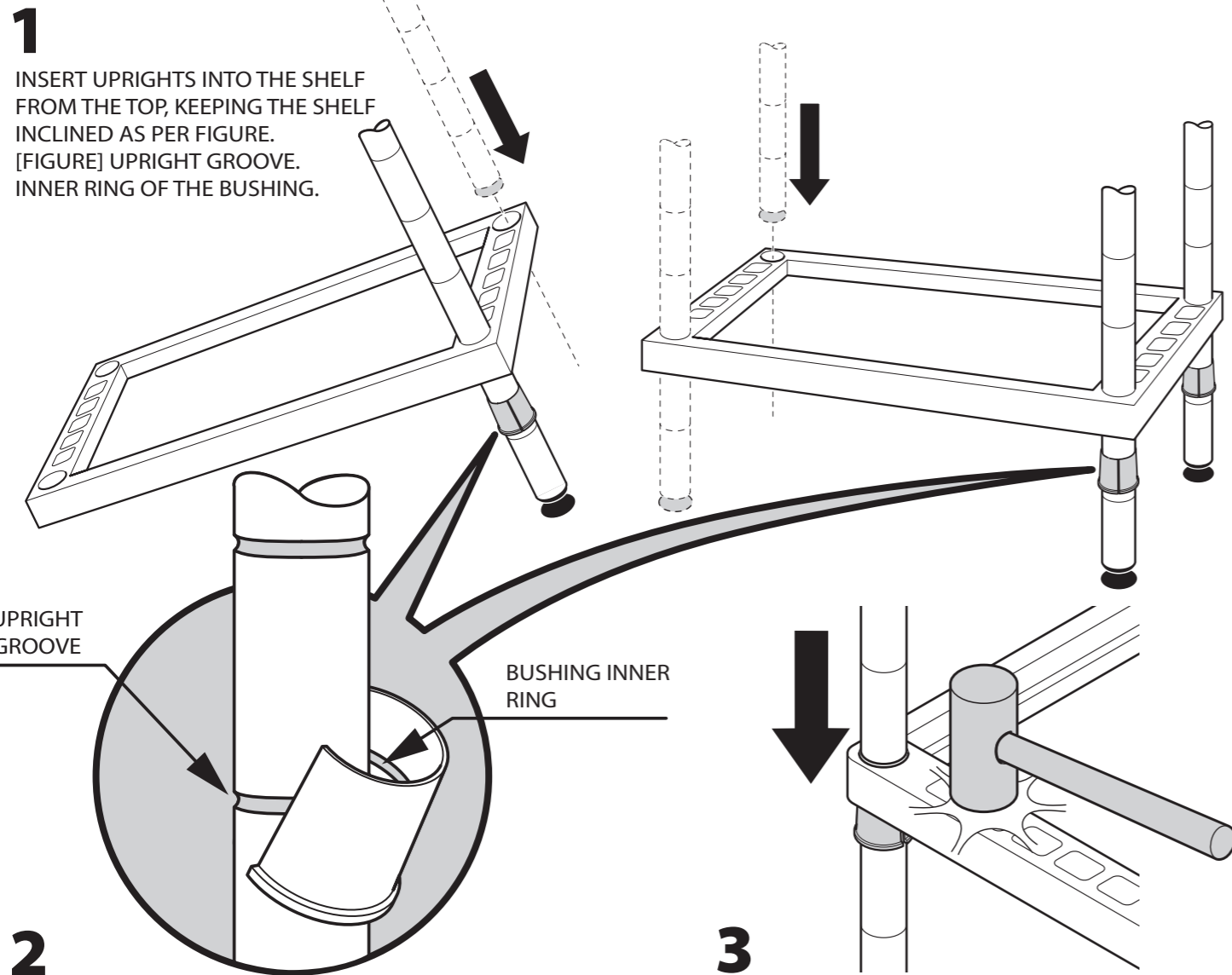

1
INSERT UPRIGHTS INTO THE SHELF FROM THE TOP, KEEPING THE SHELF INCLINED AS PER FIGURE. [FIGURE] UPRIGHT GROOVE. INNER RING OF THE BUSHING.

UPRIGHT GROOVE
BUSHING INNER RING

2
MOUNT THE BUSHING ONTO THE UPRIGHT AT THE REQUIRED HEIGHT.

! ENSURE THE BUSHING IS INSERTED PROPERLY INTO THE GROOVE, OTHERWISE THE SHELF COULD SLIDE.

3
FIX THE SHELVES ONTO THE BUSHINGS, AS INDICATED IN THE FIGURE.

! MAKE SURE THAT THE BUSHING WON'T SLIDE ON THE UPRIGHT DURING THE FITTING OF THE SHELF.

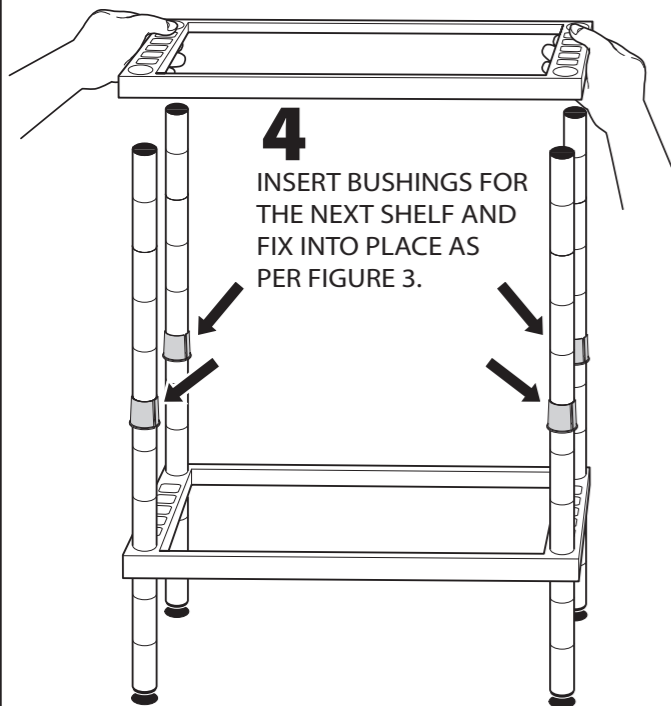

4
INSERT BUSHINGS FOR THE NEXT SHELF AND FIX INTO PLACE AS PER FIGURE 3.

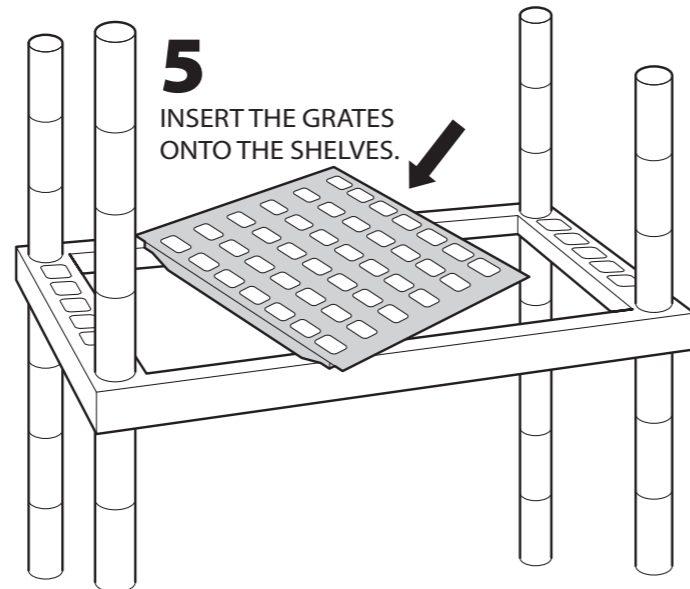

5
INSERT THE GRATES ONTO THE SHELVES.

RACK ASSEMBLY INSTRUCTIONS

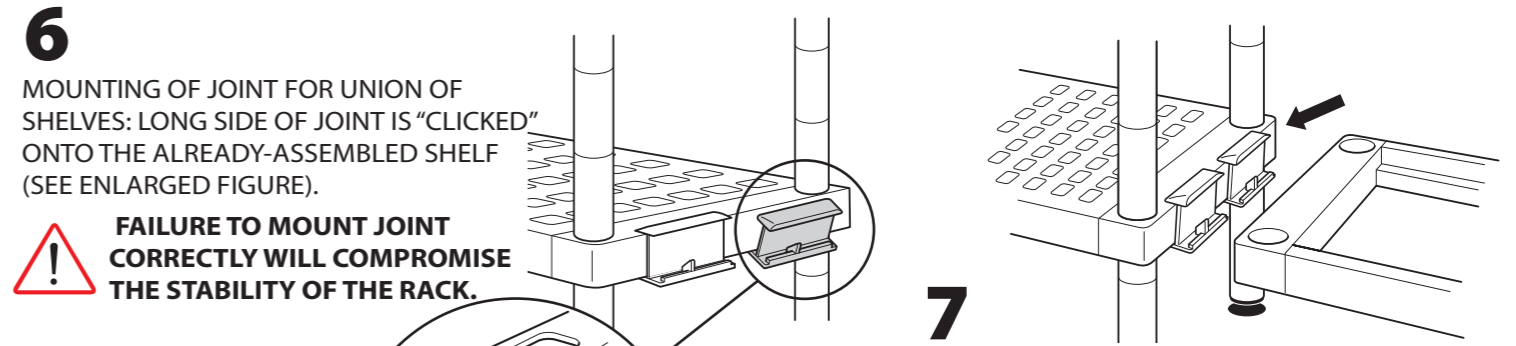

6
MOUNTING OF JOINT FOR UNION OF SHELVES: LONG SIDE OF JOINT IS "CLICKED" ONTO THE ALREADY-ASSEMBLED SHELF (SEE ENLARGED FIGURE).

! FAILURE TO MOUNT JOINT CORRECTLY WILL COMPROMISE THE STABILITY OF THE RACK.

UPPER LONG SIDE

LOWER TAB

7
JOIN THE NEXT SHELF WITH THE SHELF THAT HAS THE UPRIGHTS ALREADY INSERTED. ENSURE THE SHELVES ARE JOINED CORRECTLY ALONG THE LOWER TAB OF THE JOINT (SEE ENLARGED FIGURE).

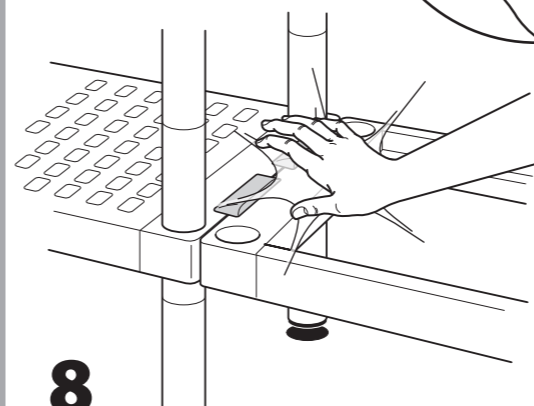

8
FIX THE SHELF ONTO THE JOINTS USING HAND PRESSURE.

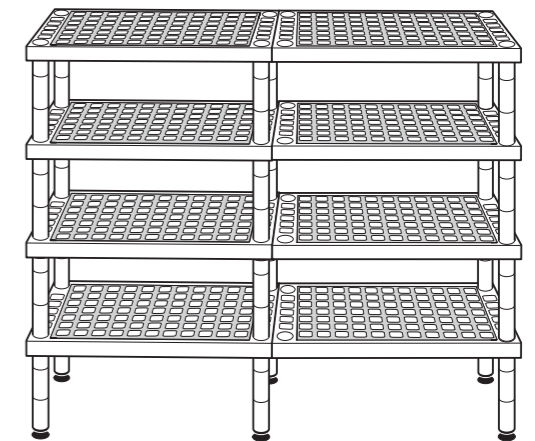

TRANSVERSAL RACK ASSEMBLY INSTRUCTIONS

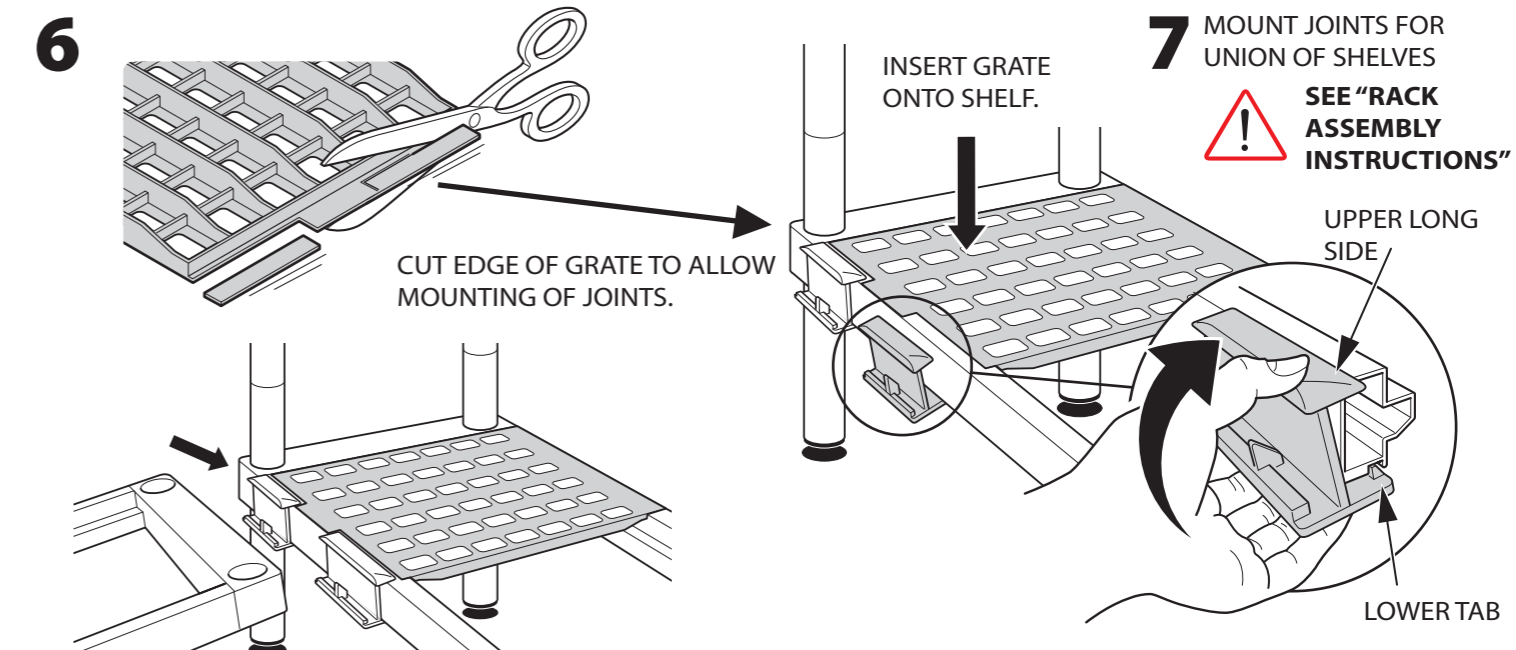

6
CUT EDGE OF GRATE TO ALLOW MOUNTING OF JOINTS.

INSERT GRATE ONTO SHELF.

7 MOUNT JOINTS FOR UNION OF SHELVES
! SEE "RACK ASSEMBLY INSTRUCTIONS"

UPPER LONG SIDE

LOWER TAB

8
FIX THE SHELF ONTO THE JOINTS USING HAND PRESSURE.